



INTERNATIONAL STANDARD ISO 10721-2:1999 TECHNICAL CORRIGENDUM 1

Published 1999-11-01

INTERNATIONAL ORGANIZATION FOR STANDARDIZATION • МЕЖДУНАРОДНАЯ ОРГАНИЗАЦИЯ ПО СТАНДАРТИЗАЦИИ • ORGANISATION INTERNATIONALE DE NORMALISATION

Steel structures — Part 2: Fabrication and erection

TECHNICAL CORRIGENDUM 1

Structures en acier —

Partie 2: Fabrication et montage

RECTIFICATIF TECHNIQUE 1

Technical Corrigendum 1 to International Standard ISO 10721-2:1999 was prepared by Technical Committee ISO/TC 167, *Steel and aluminium structures*, Subcommittee SC 2, *Steel: Fabrication and erection*.

Page 41

Relace the existing Figure D.1 with new Figure D.1 shown below, in which drawings f) and g) have been rearranged and a section view added to g) for clarification, and in which the word **Key** has been added in the lower left above the description of element 1.

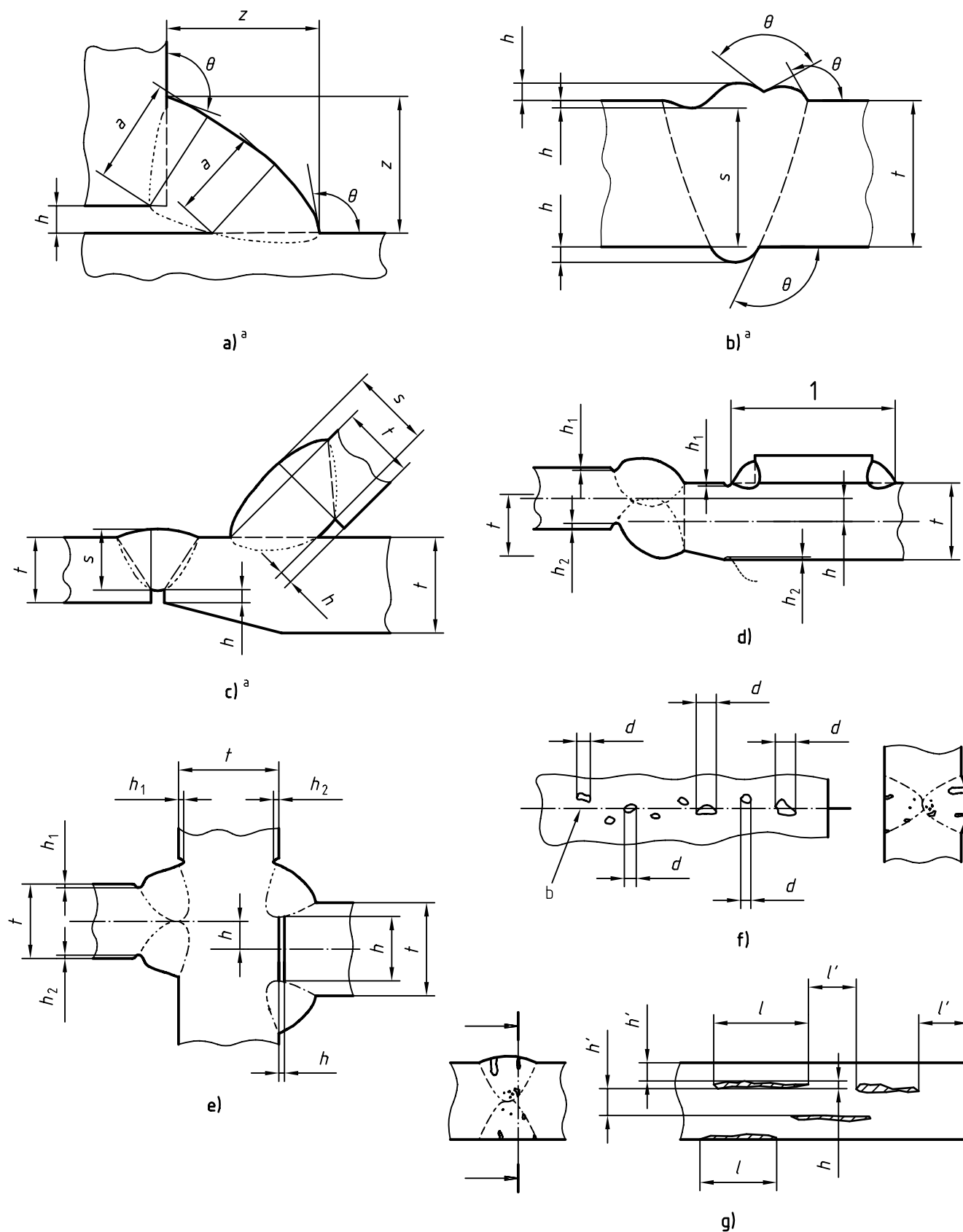

Key

- 1 Attachment length
- ^a a and s are minimum distances
- ^b See note 8 in Table D.3

Figure D.1 — Acceptance requirements for production welds in steel structures

Page 42

In subclause **D.5.2**, second line of item ii), replace "... 2×10^6 cycles, the four fatigue qualities FAT 71..." with the following text:

"... 2×10^6 cycles, one of the four fatigue qualities FAT 71..."